

GP Component

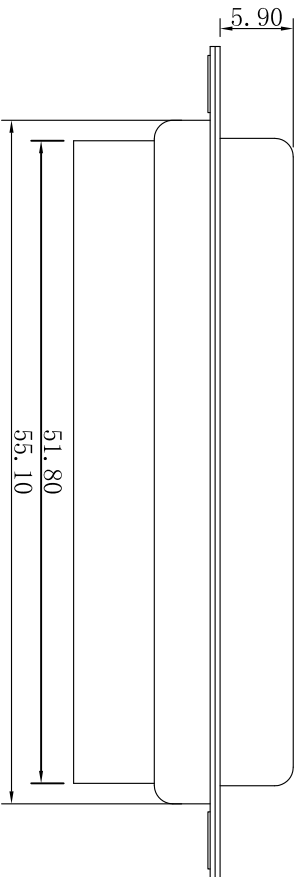

Specification Type

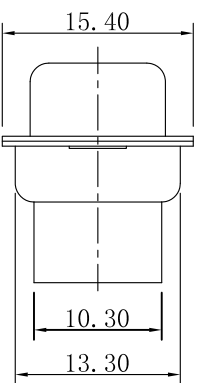
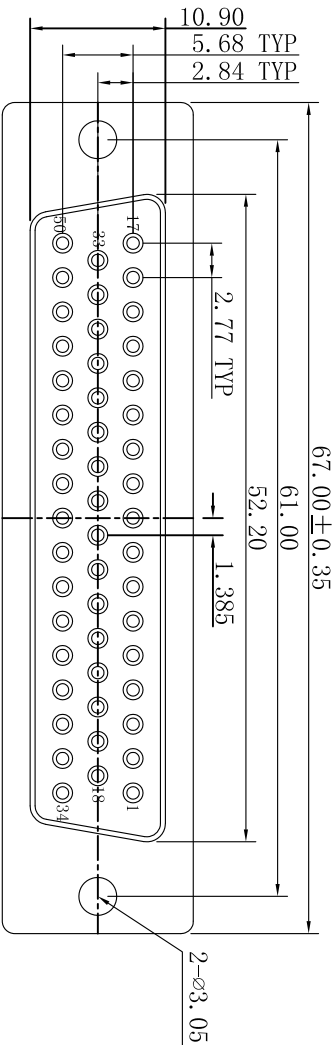
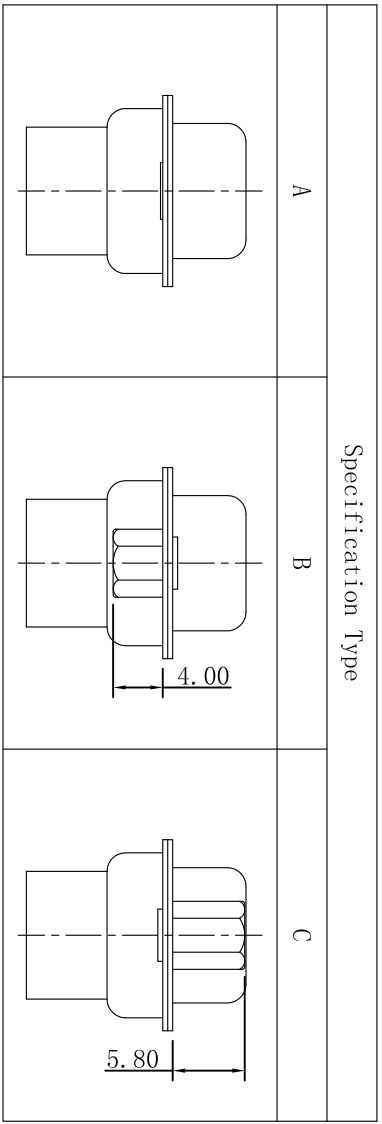

REV.	ECN NO.	LOCATIONS	DESCRIPTION	DATE	DESIGN
A0			原始版本(INITIAL EDITION)	2021.01.04	m t

CHARACTERISTICS:

1. RATED VOLTAGE: 250V
2. RATED CURRENT: 3.0AMP
3. CONTACT RESISTANCE: 30mΩ Max.
4. INSULATION RESISTANCE: 1000 MΩ MIN. 500V DC
5. Electric Pressure: Keeping 60 second in AC 500V/1mA
6. Operating temperature: -55℃~105℃
7. INSERTION/EXTRACTION FORCE PER CONTACT: 14Kg Max 1.6Kg Min.

01.DEC050 F X XXX XX A XXX

PIN Poles	50:50PIN				
M/F Differentiates	M=Male F=Female				
Hsg Color	1=Black 3=Blue 2=White 4=Green 5=Yellow 6=Purple				
Plating	G00:Gold flash G01:Gold 1U" G03:Gold 3U" Gxx:Gold XXU"				
	B00:Braight sn B01:Braight sn 1U" B03:Braight sn 3U" Bxx:Braight sn XXU"				
	M00:Matte sn M01:Matte sn 1U" M03:Matte sn 3U" Mxx:Matte sn XXU"				

<p>东莞市跃展精密连接器有限公司 Dongguan YueZhan Precision Connectors Co., Ltd</p>	UNITS: mm [inch]	DESIGN: 车涛	2021.01.04	PART NAME: DEC 50F系列图
	TOLERANCE: X.X ±0.35 X.XX ±0.25 X.XXX ±0.15 Angle ±3.0°	CHECKED: 车涛	2021.01.04	PART NO. 01.DEC050FXXXXXXXXXX
SCALE:1:1 SIZE:A4	APPROVED: 车涛	2021.01.04	DRAW NO.	SHEET NO. 01 OF 01