

GP Component

| REV. | ECN NO. | LOCATIONS | DESCRIPTION | DATE | DESIGN |
|------|---------|-----------|-----------------------|------------|--------|
| A0 | | | 原始版本(INITIAL EDITION) | 2021.01.04 | m t |

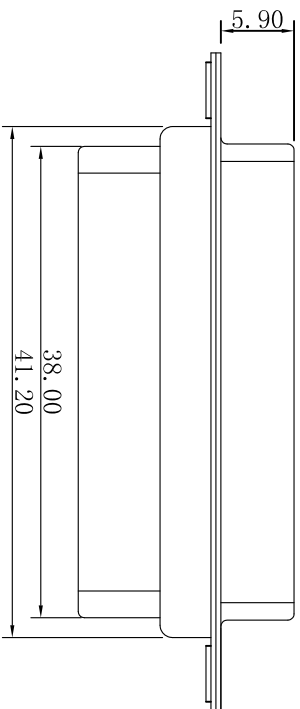
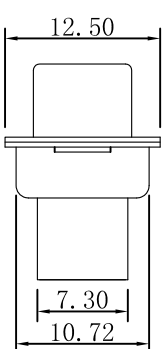
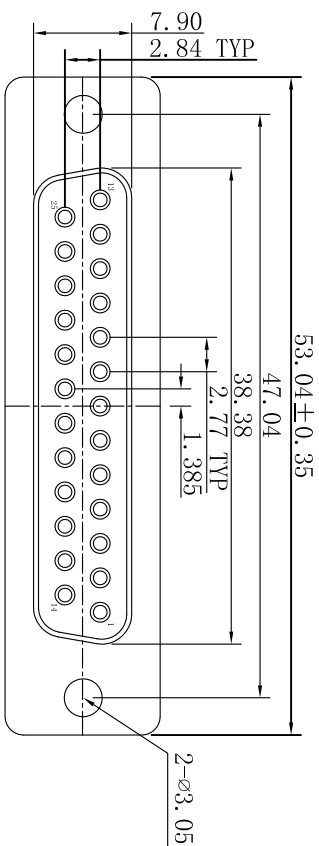

Specification Type

| Specification Type | A | B | C |
|--------------------|---|---|---|
| | | | |

CHARACTERISTICS:

1. RATED VOLTAGE: 250V
2. RATED CURRENT: 3.0AMP
3. CONTACT RESISTANCE: 30mΩ Max.
4. INSULATION RESISTANCE: 1000 MΩ MIN. 500V DC
5. Electric Pressure: Keeping 60 second in AC 500V/1mA
6. Operating temperature: -55℃~105℃
7. INSERTION/EXTRACTION FORCE PER CONTACT: 8.5Kg Max 0.75Kg Min.

01.DEC025 F X XXX XX A XXX

| | | | | | |
|--------------------|---|---|---|--|--|
| PIN Poles | 25:25PIN | | | | |
| M/F Differentiates | M=Male F=Female | | | | |
| Hsg Color | 1=Black 3=Blue 2=White 4=Green 5=Yellow 6=Purple | | | | |
| Plating | G00:Gold flash G01:Gold 1U" G03:Gold 3U" Gxx:Gold XXU" | B00:Bright sn B01:Bright sn 1U" B03:Bright sn 3U" Bxx:Bright sn XXU" | M00:Matte sn M01:Matte sn 1U" M03:Matte sn 3U" Mxx:Matte sn XXU" | | |
| Water Code | | | | | |
| Specification Type | | | | | |
| Hsg Material | H1=PB1 HF H4=PA66 HF H5=LCF H6=PP1 H7=PA6T H8=PA66 H9=PA6T H10=PP1 H11=PA6T H12=PA9T H13=PA66 H14=PA46 | | | | |

| | | | | | |
|-----------------|---|--------------|------------|------------|----------------------|
| UNTR: mm [inch] | 东莞市跃展精密连接器有限公司 Dongguan YueZhan Precision Connectors Co.,Ltd | DESIGN: 车涛 | 2021.01.04 | PART NAME: | DEC 25F系列图 |
| | | CHECKED: 车涛 | 2021.01.04 | PART NO.: | 01.DEC025FXXXXXXXXXX |
| TOLERANCE: | X.X ±0.35 X.XX ±0.25 X.XXX ±0.15 Angle ±3.0° | APPROVED: 车涛 | 2021.01.04 | DRAW NO.: | 01 OF 01 |
| SCALE:1:1 | SIZE:A4 | SHEET NO.: | | | |